

# Modul-Compact 30 compact Signal tower



Compact

- Ø 30 mm ready-to-use pre-assembled signal tower series
- 1 m pre-wiring as standard
- LED steady/strobe beacon modules in 6 colours
- One-tone and two-tone piezo buzzer modules available
- Pre-assembled towers or individually configured towers available
- Housing colours black or grey
- Extensive range of mounting types
- PLC-suitable
- High degree of protection IP65, UL type 4/4X/13

## TECHNICAL DATA

Housing	Ø 30 mm, Polycarbonate black (RAL 9005) or grey (RAL 7035)
Lens	Polycarbonate, ribbed inside orange, red, clear, blue, green or yellow
Type of mounting	any
Connection technology	pre-wired, special lengths available on request
Leakage current	0,003 A (PLC-suitable)
Beacon type	LED steady beacon or LED flashing beacon
Light source	LEDs
Strobe/flash frequency	Flashing beacon 2 Hz
Tone	Steady tone, Pulsing tone or Steady or pulsing tone (depending on module)
Volume	85 dB
Tone frequency	4.500 Hz
Duty cycle	100 %
Service life	Light source: 100.000 h
Number of possible modules	max. 5
Operating temperature	-25 °C / +50 °C
Degree of protection	IP65 & UL Type 4/4X/13
Weight (modules)	15-20 g



## Modul-Compact 30



Order number: C30-Q01  
Colours: red/orange/green  
Function: LED steady beacon  
Nominal voltage: 24 V AC/DC  
Type of mounting: horizontal



Order number: C30-Q02  
Colours: red/green  
Function: LED steady beacon  
Nominal voltage: 24 V AC/DC  
Type of mounting: horizontal



Order number: C30-Q07  
Colours: red/yellow/green  
Function: LED steady beacon  
Nominal voltage: 24 V AC/DC  
Type of mounting: horizontal



Order number: C30-Q41  
Colours: red/orange/green  
Function: LED steady beacon, buzzer steady or pulsing tone  
Nominal voltage: 24 V AC/DC  
Type of mounting: horizontal



Order number: C30-Q601  
Colours: red/orange/green  
Function: LED steady beacon  
Nominal voltage: 24 V AC/DC  
Type of mounting: horizontal



Order number: C30-Q602  
Colours: red/green  
Function: LED steady beacon  
Nominal voltage: 24 V AC/DC  
Type of mounting: horizontal



Order number: C30-Q607  
Colours: red/yellow/green  
Function: LED steady beacon  
Nominal voltage: 24 V AC/DC  
Type of mounting: horizontal



Order number: C30-Q641  
Colours: red/orange/green  
Function: LED steady beacon, buzzer steady or pulsing tone  
Nominal voltage: 24 V AC/DC  
Type of mounting: horizontal



Compact

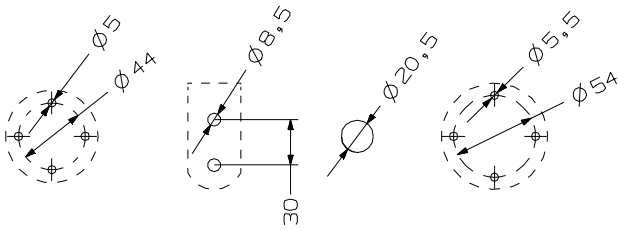
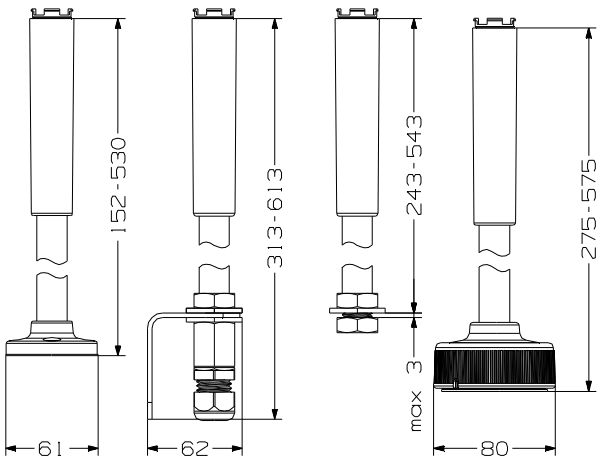
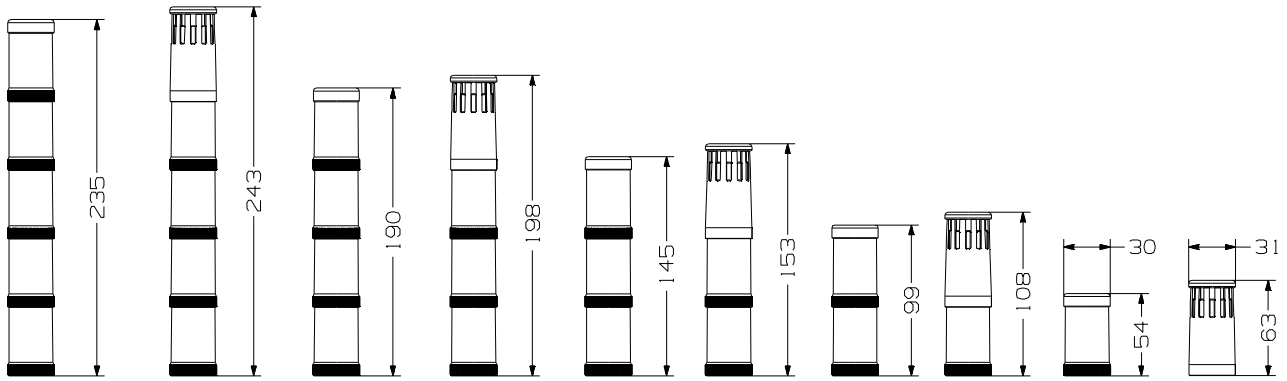

# Modul-Compact 30

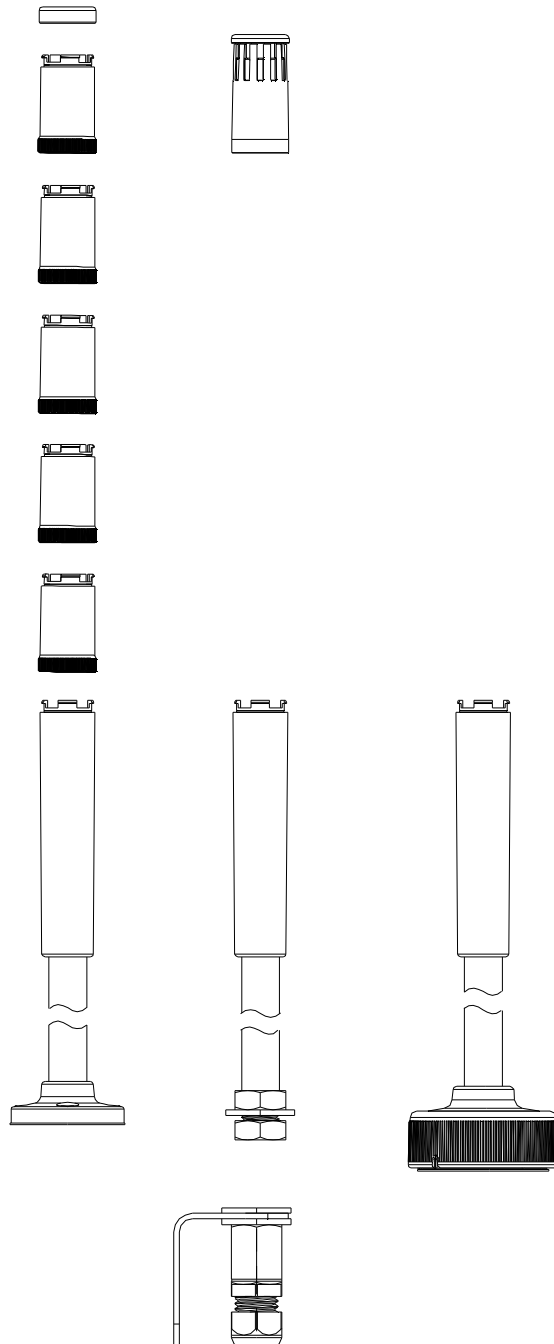

# Modul-Compact 30

## ORDER NUMBER LOGIC

An order number for Modul-Compact 30 always begins with "C30". Select your preferred configuration from each category and enter your choices in the numbered boxes. A configuration for a module is always made up of 2 parts. The module type (a) and the lens colour (b).

An example of an order number would be:

**C30 P1 C1 B 20 B1 L5 L4 B2 DP**

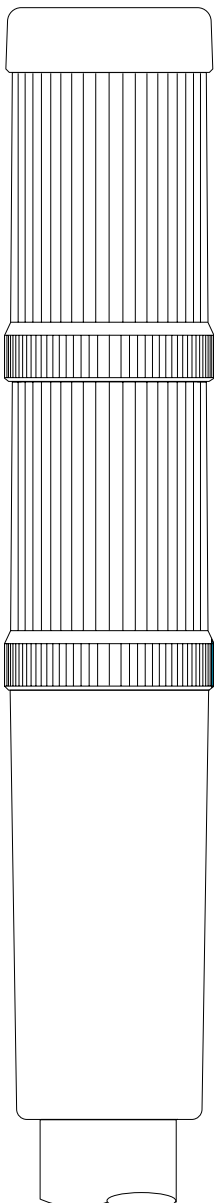

### 2<sup>ND</sup> MODULE

This module is the 6<sup>th</sup> element of the order number.

### 1<sup>ST</sup> MODULE

This module is the 5<sup>th</sup> element of the order number.

## BASE (1)

CMR	Pole mount base on aluminium tube with plastic foot	0 mm	P0
		100 mm	P1
		250 mm	P2
		400 mm	P4
CSW	Pole mount base on aluminium tube for horizontal mounting with screws	0 mm	T0
		100 mm	T1
		250 mm	T2
		400 mm	T4
CFR	Pole mount base on aluminium tube with foot adapter for quick mounting	0 mm	Q0
		100 mm	Q1
		250 mm	Q2
		400 mm	Q4

## STANDARD UL CABLE, YELLOW (2)

1 m	C1
2 m	C2
3 m	C3
5 m	C5

## HOUSING COLOUR (3)

black	B
grey	G

## NOMINAL VOLTAGE (4)

24 V AC/DC	24
110/120 V AC	10
230/240 V AC	20

## MODULES (5-9)

### Module type (a)

CLL	LED steady light (1 position)	L
CLB	LED flashing light (1 position)	B
CDD	Piezo buzzer, continuous tone, 100 dB (1 position)	DD
CDP	Piezo buzzer, pulsing tone, 100 dB (1 position)	DP
CDZ	Piezo buzzer, continuous and pulsing tone, 100 dB, can be switched externally (2 positions)	DZ

### Lens colour (b)

orange	1
red	2
clear	4
blue	5
green	6
yellow	7



Compact



## Modul-Compact 70 compact Signal tower

- Ø 70 mm ready-to-use pre-assembled signal tower series
- 1 m pre-wiring as standard
- LED steady/strobe beacon modules in 6 colours
- One-tone and two-tone piezo buzzer modules available  
Pre-assembled towers or individually configured towers available
- Housing colours black or grey
- Extensive range of mounting types
- PLC-suitable
- High degree of protection IP65, UL type 4/4X/13

### TECHNICAL DATA

Housing	Ø 70 mm, Polycarbonate black (RAL 9005) or grey (RAL 7035)
Lens	Polycarbonate, ribbed inside
Type of mounting	any
Connection technology	pre-wired, special lengths available on request
Leakage current	0,003 A (PLC-suitable)
Beacon type	LED steady beacon or LED flashing beacon
Light source	LEDs
Strobe/flash frequency	Flashing beacon 2 Hz
Tone	Steady tone, Pulsing tone or Steady or pulsing tone (depending on module)
Volume	100 dB
Tone frequency	3.000 Hz
Duty cycle	100 %
Service life	Light source: 100.000 h
Operating temperature	-25 °C / +60 °C
Degree of protection	IP65 & UL Type 4/4x/13
Weight (modules)	15-20 g

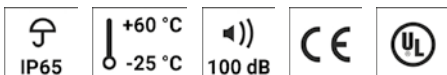

# Modul-Compact 70



Order number: C70-Q01  
Colours: red/orange/green  
Function: LED steady beacon  
Nominal voltage: 24 V AC/DC  
Type of mounting: horizontal  
Length: 100 mm



Order number: C70-Q02  
Colours: red/green  
Function: LED steady beacon  
Nominal voltage: 24 V AC/DC  
Type of mounting: horizontal  
Length: 100 mm



Order number: C70-Q07  
Colours: red/yellow/green  
Function: LED steady beacon  
Nominal voltage: 24 V AC/DC  
Type of mounting: horizontal  
Length: 100 mm



Order number: C70-Q41  
Colours: red/orange/green  
Function: LED steady beacon, buzzer steady or pulsing tone  
Nominal voltage: 24 V AC/DC  
Type of mounting: horizontal  
Length: 100 mm



Compact



Order number: C70-Q601  
Colours: red/orange/green  
Function: LED steady beacon  
Nominal voltage: 24 V AC/DC  
Type of mounting: horizontal  
Length: 100 mm



Order number: C70-Q602  
Colours: red/green  
Function: LED steady beacon  
Nominal voltage: 24 V AC/DC  
Type of mounting: horizontal  
Length: 100 mm



Order number: C70-Q607  
Colours: red/yellow/green  
Function: LED steady beacon  
Nominal voltage: 24 V AC/DC  
Type of mounting: horizontal  
Length: 100 mm



Order number: C70-Q641  
Colours: red/orange/green  
Function: LED steady beacon, buzzer steady or pulsing tone  
Nominal voltage: 24 V AC/DC  
Type of mounting: horizontal  
Length: 100 mm

# Modul-Compact 70

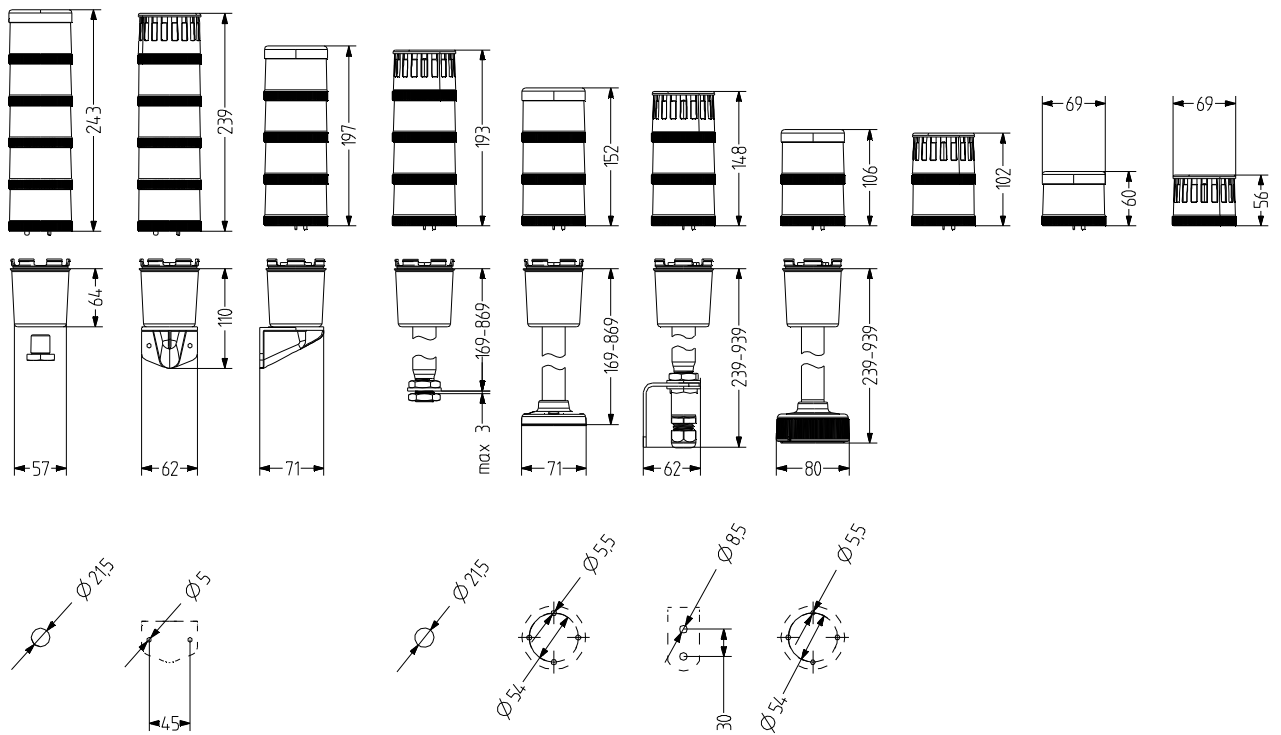



# Modul-Compact 70

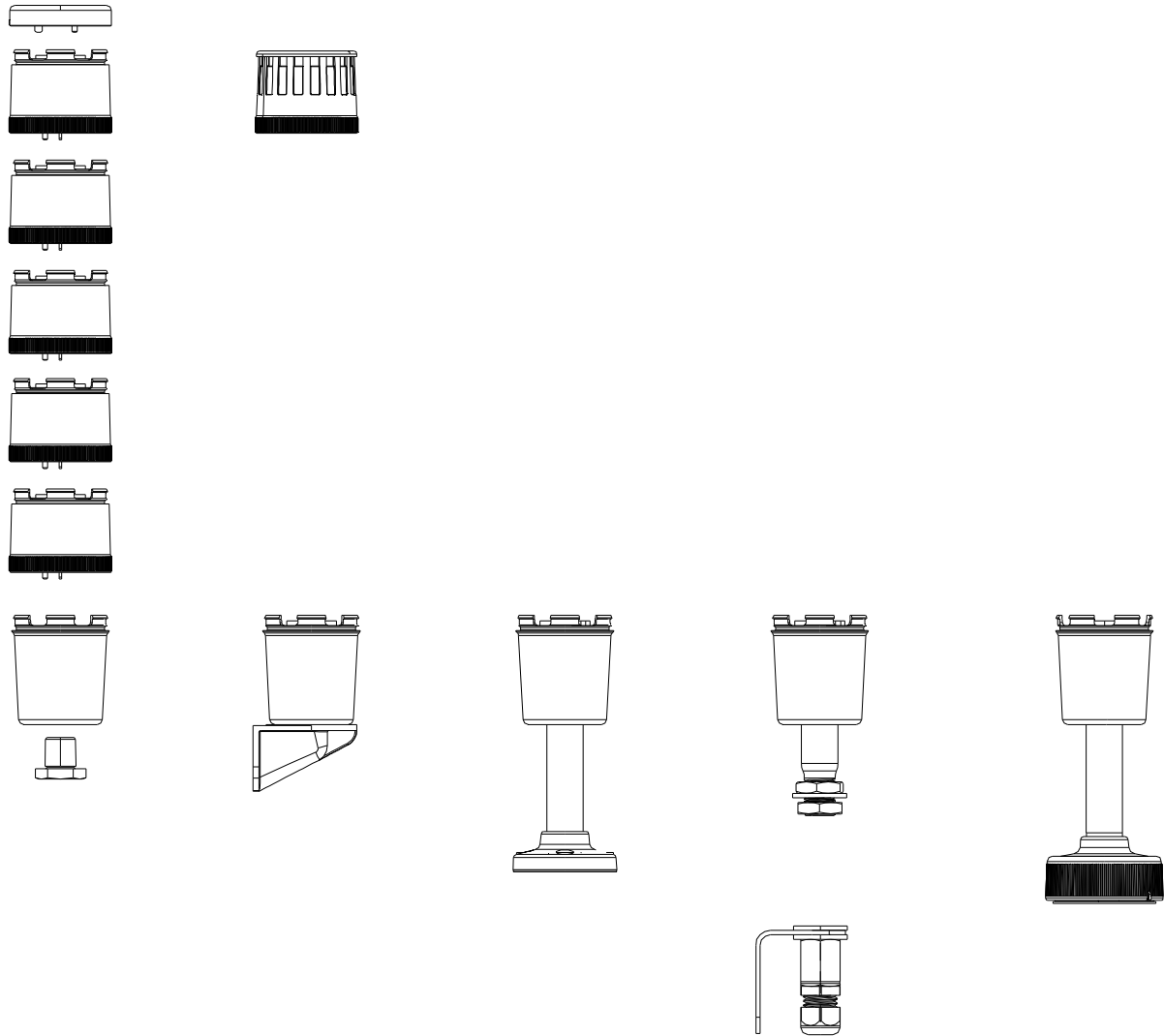

Compact

# Modul-Compact 70

## ORDER NUMBER LOGIC

An order number for Modul-Compact 70 always begins with "C70". Select your preferred configuration from each category and enter your choices in the numbered boxes.

A configuration for a module is always made up of 2 parts. The module type (a) and the lens colour (b).

An example of an order number would be:

C70 T2 C5 B 24 L6 B2

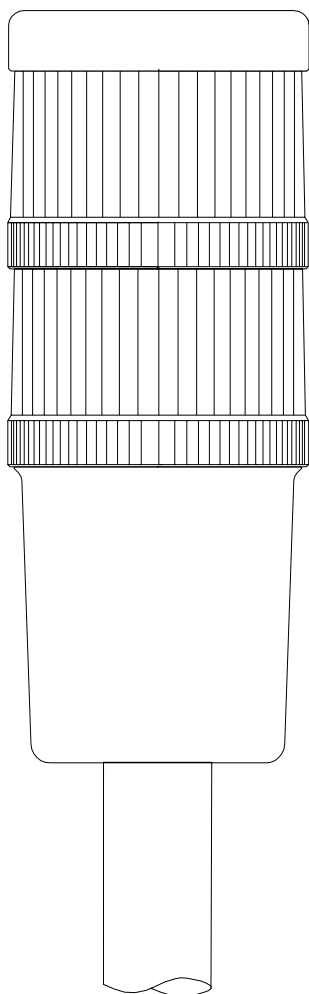

### 2<sup>ND</sup> MODULE

This module is the 6<sup>th</sup> element of the order number.

### 1<sup>ST</sup> MODULE

This module is the 5<sup>th</sup> element of the order number.

## BASE (1)

DMW	Base for horizontal mounting		B0
DMV	Base for vertical mounting		V0
DMR	Pole mount base on aluminium tube with plastic foot	50 mm	P0
		100 mm	P1
		250 mm	P2
		400 mm	P4
DSW	Pole mount base on aluminium tube for horizontal mounting with screws	50 mm	T0
		100 mm	T1
		250 mm	T2
		400 mm	T4
DFR	Pole mount base on aluminium tube with foot adapter for quick mounting	100 mm	Q1
		250 mm	Q2
		400 mm	Q4

## STANDARD UL CABLE, YELLOW (2)

1 m	C1
2 m	C2
3 m	C3
5 m	C5

## HOUSING COLOUR (3)

schwarz	B
grau	G

## NOMINAL VOLTAGE (4)

24 V AC/DC	24
110/120 V AC	10
230/240 V AC	20

## MODULES (5-9)

### Module type (a)

DLL	LED steady light (1 position)	L
DLB	LED flashing light (1 position)	B
DDD	Piezo buzzer, continuous tone, 100 dB (1 position)	DD
DDP	Piezo buzzer, pulsing tone, 100 dB (1 position)	DP
DDZ	Piezo buzzer, continuous and pulsing tone, 100 dB, can be switched externally (2 positions)	DZ

### Lens colour (b)

orange	1
red	2
clear	4
blue	5
green	6
yellow	7

