



Accessories / Index

Accessories		Page
Overviews	Adapter front bezel	302
	Sealing cover	303
	Transparent cover	304
	Socket boxes	305
	Front bezel	305
	Mounting frame	306
	DIN rail mount	306
	Enclosure blind	307
	Other accessories	307
Details	Adapter front bezel	308
	Sealing cover	311
	Transparent cover	312
	Socket boxes	315
	Front bezel	317
	Mounting frame	318
	DIN rail mount	319
	Enclosure blind	320
	Other accessories	321
Gaskets		323
Index		Page
List of order numbers		324
Addresses		328



Accessories

Overview

Adapter front bezel						counter 48 x 24 mm [1.89 x 0.94"]						counter 48 x 48 mm [1.89 x 1.89"]				counter 96 x 48 mm [3.78 x 1.89"]		
Figure	Size	for cut-out	to cut-out	Order-No.:	Details s. page	Codix 13x	Codix 14x	Codix 52x	Codix 53x	W 1x.5	H 37, H 37.5	Codix 71x	Codix 90x, 92x	901	H 57, HC 77, HW 66	Codix 54x	Codix 56x	Codix 57x
	53 x 28 mm [2.09 x 1.10"]	50 x 25 mm [1.97 x 0.98"]	45 x 22.2 mm [1.77 x 0.94"]	grey black anthracite	T008164 T008165 T008180	306	X	X	X	X	X							
	56 x 40 mm [2.20 x 1.57"]	50 x 25 mm [1.97 x 0.98"]	45 x 22.2 mm [1.77 x 0.94"]	black anthracite	T008161 T008181	306	X	X	X	X	X							
	72 x 36 mm [2.83 x 1.42"]	68 x 33 mm [2.68 x 1.30"]	45 x 22.2 mm [1.77 x 0.94"]	black and silver anodised as set	162704 Set	306	X	X	X	X	X							
	60 x 50 mm [2.36 x 1.97"]	54 x 29 mm [2.13 x 1.14"]	45 x 22.2 mm [1.77 x 0.94"]	black	N003001	307	X	X	X	X	X							
	48 x 48 mm [1.89 x 1.89"]	45 x 45 mm [1.77 x 1.77"]	45 x 22.2 mm [1.77 x 0.94"]	black	T008883	307	X	X	X	X	X							
	55 x 55 mm [2.16 x 2.16"]	50 x 50 mm [1.97 x 1.97"] or ø 50.5 mm [1.99"]	45 x 45 mm [1.77 x 1.77"]	grey black	T008170 T008171	307						X			X			
	55 x 55 mm [2.16 x 2.16"]	50 x 50 mm [1.97 x 1.97"]	45 x 45 mm [1.77 x 1.77"]	black	T008853	307						X	X	X	X			
	60 x 75 mm [2.36 x 2.95"]	50 x 50 mm [1.97 x 1.97"]	45 x 45 mm [1.77 x 1.77"]	black	T008860	308						X	X	X	X			
	72 x 72 mm [2.83 x 2.83"]	68 x 68 mm [2.68 x 2.68"]	45 x 45 mm [1.77 x 1.77"]	grey black mating clip	T008176 T008177 T009420	308						X	X	X	X			
	ø 72 mm [2.83"]	ø 60 mm [2.36"]	45 x 45 mm [1.77 x 1.77"]	black	N510226	308						X	X	X	X			

Accessories

Overview

Sealing cover					for electromechanical counters						counter 48 x 24 mm [1.89 x 0.94"] ¹⁾		counter 48 x 48 mm [1.89 x 1.89"] ²⁾				
Figure	Type	Description	Order-No.:	Details s. page	B 1x.3x	HB 2x.3x	BVa 15.3x	HVa 15.3x	MVs 16.3x	MVs 13.1x	Codix 13x, 14x	Codix 52x, 53x	W 1x.5	H 37, H 37.5	Codix 71x	Codix 90x, 92x	901
	K1	for front bezel 60 x 50 mm [2.36 x 1.97"]	transparent / grey transparent / black	G008300 G008301	309	X	X				X	X	X	X			
	K2	for front bezel 75 x 60 mm [2.95x 2.36"]	transparent / grey transparent / black	G008302 G008303	309			X	X	X					X	X	X
	KV3	for front bezel 39 x 68 mm [1.54 x 2.68"]	transparent / grey transparent / black	G008310 G008311	309					X							

1) via adapter front bezel N003001

2) via adapter front bezel T008860

Accessories

Overview



Transparent cover					for electromechanical counters				counter 48 x 24 mm [1.89 x 0.94"] ¹⁾			counter 48 x 48 mm [1.89 x 1.89"]						
Figure	Type	Description	Order-No.:	Details s. page	Dv B 1x, Dv HB 2x	Dvs B 1x, Dvs HB 2x	Dv BVa 15, Dv HVa 15, Dv MVs 16	Dvs BVa 15, Dvs HVa 15, Dvs MVs 16	B 1x.3x, HB 2x.3x	B 1x.0x, HB 2x.0x	Codix 13x, 14x	Codix 52x, 53x	W 1x.5	H 37, H 37.5	Codix 71x	Codix 90x, 92x	901	H 57, HC 77, HW 66
	1 Dv (replacement part)	lockable cover, IP65 for size F1	transparent	G008121	310	X												
	1 Dvs (replacement part)	key lockable cover, IP65 for size F1	transparent	G008131	310		X											
	2 Dv (replacement part)	lockable cover, IP65 for size F2	transparent	G008141	310			X										
	2 Dvs (replacement part)	key lockable cover, IP65 for size F2	transparent	G008151	311			X										
	2 Dv (mounted on bezel)	lockable cover, IP65 for cut-out 50 x 50 mm [1.97 x 1.97"]	transparent / black	G008143	311										X	X	X	X
	2 Dvs (mounted on bezel)	key lockable cover, IP65 for cut-out 50 x 50 mm [1.97 x 1.97"]	transparent / black	G008153	311										X	X	X	X
	1 Dv (mounted on bezel)	lockable cover, IP65 for cut-out 54 x 29 mm [2.13 x 1.14"]	transparent / black	N003002	312				X	X ²⁾	X	X	X	X				



2) with front bezel
F1B

1) with adapter
front bezel
N003001

Accessories



Overview

Socket boxes					for electromechanical counters				
Figure	Type	Description	Order-No.:	Details s. page	B 1x.0x, HB 2x.0x	MVs 16.0	BVa 15, HVa 15		
	945.2	for plug-in connection in front bezel F1B	black G008434	313	X				
	926.1	for plug-in connection in front bezel F2M	transparent G008433	314		X			
	946.1	for plug-in connection in front bezel F2B	black G008439	314			X		



Front bezel					for electromechanical counters				
Figure	Type	Description	Order-No.:	Details s. page	B 1x.0x, HB 2x.0x (in socket box type 945.2)	BVa 15.0x (in socket box type 946.1)	2 x B or HB counters (in 2x socket box 945.2)	MVs 16.0x (in socket box type 926.1)	
	F1B	for cut-out 54 x 49 mm [2.13 x 1.93"]	beige black G007501 G007502	315	X				
	F2B	for cut-out 54 x 54 mm [2.13 x 2.13"]	beige black G007503 G007504	315		X	X		

Accessories

Overview



Mounting frame						for electrom. counters			counter 48 x 24 mm [1.89 x 0.94"] ¹⁾			counter 48 x 48 mm [1.89 x 1.89"]			c. 96 x 48 mm [3.78 x 1.89"]		
Figure	Cut-out	Description	Order-No.:	Details s. page	BVa 15.21, HVa 15.21	MVs 16.2x	B 1x, 2x, HB 2x, 2x	Codix 13x, 14x	Codix 52x, 53x	W 1x, 5	H 37, H 37.5	Codix 71x	Codix 90x, 92x	901	H 57, HC 77, HW 66	Codix 54x, 55x	Codix 56x, 57x
	92 x 45 mm [3.62 x 1.77"]	For snap-on mounting on 35 mm [1.38"] top-hat DIN rail	grey G300005	316												X	X
	50 x 50 mm [1.97 x 1.97"] (45 x 45 mm [1.77 x 1.77"] via supplied adapter)	For snap-on mounting on 35 mm [1.38"] top-hat DIN rail	chromated G300003	316	X	X						X	X	X	X		
	50 x 25 mm [1.97 x 0.98"] (45 x 22.2 mm [1.77 x 0.87"] via separate adapter)	For snap-on mounting on 35 mm [1.38"] top-hat DIN rail	chromated G300004	316			X	X	X	X	X						





1) via adapter T008180

DIN rail mount					for electrom. counters		
Figure	Type	Description	Order-No.:	Details s. page	B and HB counter	2 x B and HB counter	BVa and HVa counter
	SR 1	For snap-on mounting on 35 mm [1.38"] top-hat DIN rail	G300000	317	X		
	SR 2	For snap-on mounting on 35 mm [1.38"] top-hat DIN rail	G300001	317		X	
	SR 3	For snap-on mounting on 35 mm [1.38"] top-hat DIN rail	G300002	317			X

Accessories

Overview

Enclosure blind					counter 48 x 24 mm [1.89 x 0.94"]				counter 53 x 28 mm [2.09 x 1.10"]	
Figure	Size	Cut-out	Order-No.:	Details s. page	Codix 13x, 14x	Codix 52x, 53x	W 1x.5	H 37, H 37.5	B and HB counters	
	48 x 24 mm [1.89 x 0.94"]	for cut-out 45 x 22.2 mm [1.77 x 0.87"] and 50 x 25 mm [1.97 x 0.98"]	anthracite G003836	318	X	X	X	X		
	53 x 28 mm [2.09 x 1.10"]	for cut-out 50 x 25 mm [1.97 x 0.98"]	black T005753	318					X	

Other accessories					for counters			
Figure	Description	Order-No.:	Details s. page	H 37	H 57	HR 76.2	HR 47	
	Terminal cover type KA 37	transparent T051687	319	X				
	Base-mount socket	black G008040	319		X			
	Mounting support	black N510199	319			X	X	
	Adapter and anti-vibration set	black 255319	320				X	

Accessories

Adapter front bezel

Details

Dimensions / Details

Adapter front bezel, 53 x 28 mm [2.09 x 1.10"]

with clip mounting
for counters 48 x 24 mm [1.89 x 0.94"]



cut-out:

for cut-out 50 x 25 mm [1.97 x 0.98"]
to cut-out 45 x 22.2 mm [1.77 x 0.94"]

suitable for:

Codix 13x, 14x, 52x, 53x,
W 15.5, W 16.5, W 17.5,
H 37, H 37.5

grey
black
anthracite

Order-No.

T008164
T008165
T008180

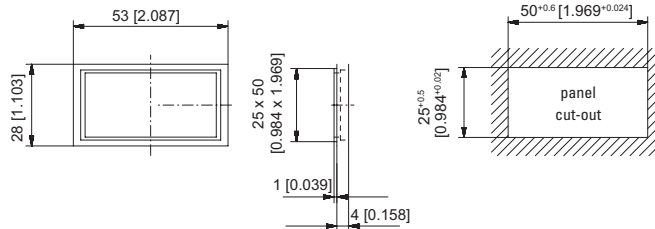

Adapter front bezel, 56 x 40 mm [2.20 x 1.57"]

with screw mounting
for counters 48 x 24 mm [1.89 x 0.94"]



cut-out:

for cut-out 50 x 25 mm [1.97 x 0.98"]
to cut-out 45 x 22.2 mm [1.77 x 0.94"]

suitable for:

Codix 13x, 14x, 52x, 53x,
W 15.5, W 16.5, W 17.5,
H 37, H 37.5

black
anthracite

Order-No.

T008161
T008181

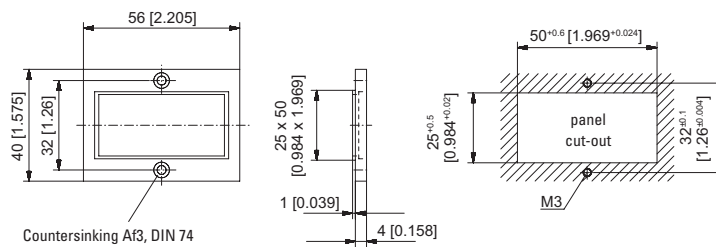

Adapter front bezel, 72 x 36 mm

for counters 48 x 24 mm [1.89 x 0.94"]

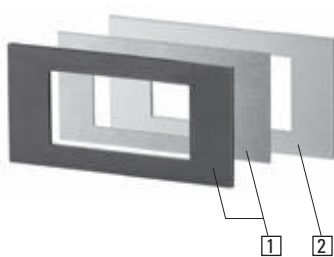

1 Front bezel
(1 x black, 1 x silver anodised)

2 Bezel adapter

cut-out:

for cut-out 68 x 33 mm [2.68 x 1.30"]
to cut-out 45 x 22.2 mm [1.77 x 0.94"]

suitable for:

Codix 13x, 14x, 52x, 53x,
W 15.5, W 16.5, W 17.5,
H 37, H 37.5

black and
silver anodised
as set

Order-No.

162704 Set

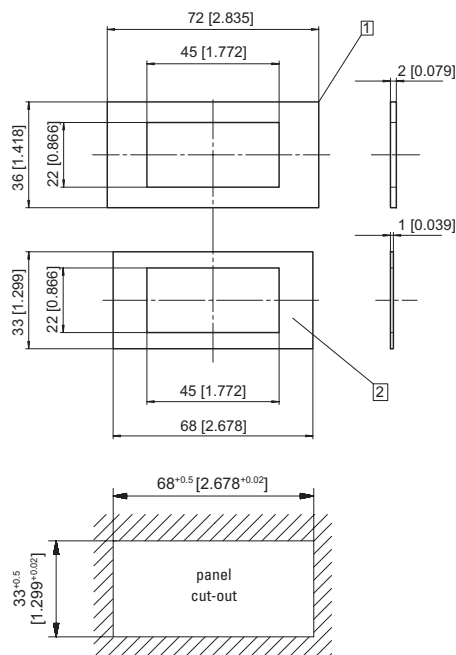

Accessories

Adapter front bezel Details

Dimensions / Details

Adapter front bezel, 60 x 50 mm [2.36 x 1.97"]

with screw mounting, incl. gasket
for counters 48 x 24 mm [1.89 x 0.94"]



cut-out:

for cut-out 54 x 29 mm [2.13 x 1.14"]
to cut-out 45 x 22.2 mm [1.77 x 0.94"]

suitable for:

Codix 13x, 14x, 52x, 53x, black
W 15.5, W 16.5, W 17.5,
H 37, H 37.5

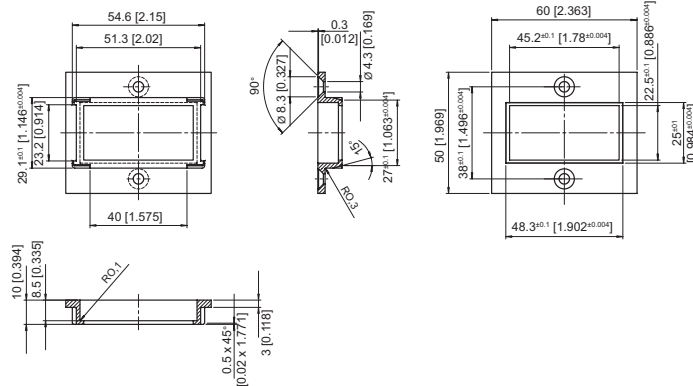

Order-No.

N003001

Adapter front bezel, 48 x 48 mm [1.89 x 1.89"]

with clip mounting
for counters 48 x 24 mm [1.89 x 0.94"]



cut-out:

for cut-out 45 x 45 mm [1.77 x 1.77"]
to cut-out 45 x 22.2 mm [1.77 x 0.94"]

suitable for:

Codix 13x, 14x, 52x, 53x, black
W 15.5, W 16.5, W 17.5,
H 37, H 37.5

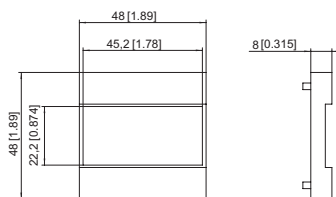

Order-No.

T008883

Adapter front bezel, 55 x 55 mm [2.16 x 2.16"]

with clip mounting
for counters 48 x 48 mm [1.89 x 1.89"]



cut-out:

for cut-out 50 x 50 mm [1.97 x 1.97"]
or \varnothing 50.5 mm [1.99"]
to cut-out 45 x 45 mm [1.77 x 1.77"]

suitable for:

Codix 716 / 717, grey
H 57, HC 77, HW 66, HW 66 M black

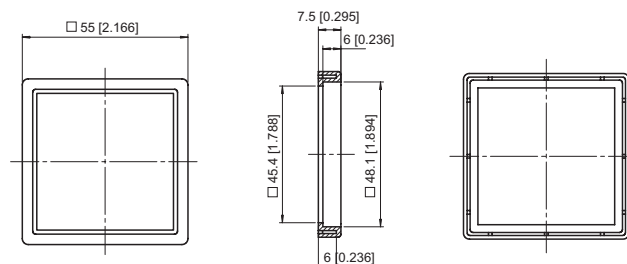

Order-No.

T008170

T008171

Adapter front bezel, 55 x 55 mm [2.16 x 2.16"]

with clip mounting
for counters 48 x 48 mm [1.89 x 1.89"]



cut-out:

for cut-out 50 x 50 mm [1.97 x 1.97"]
to cut-out 45 x 45 mm [1.77 x 1.77"]

suitable for:

901, Codix 716 / 717, black
Codix 923 / 924, Codix 907 / 908,
H 57, HC 77, HW 66

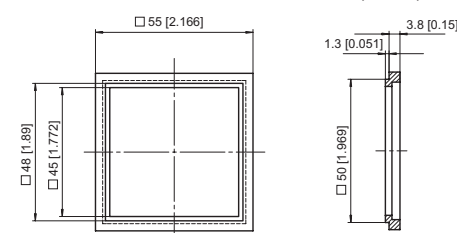

Order-No.

T008853

Accessories

Adapter front bezel Details

Dimensions / Details

Adapter front bezel, 60 x 75 mm [2.36 x 2.95"]

with screw mounting
for counters 48 x 48 mm [1.89 x 1.89"]



cut-out:

for cut-out 50 x 50 mm [1.97 x 1.97"]
to cut-out 45 x 45 mm [1.77 x 1.77"]

suitable for:

901, Codix 716 / 717,
Codix 923 / 924, Codix 907 / 908,
H 57, HC 77, HW 66, HW 66 M

black

Order-No.

T008860

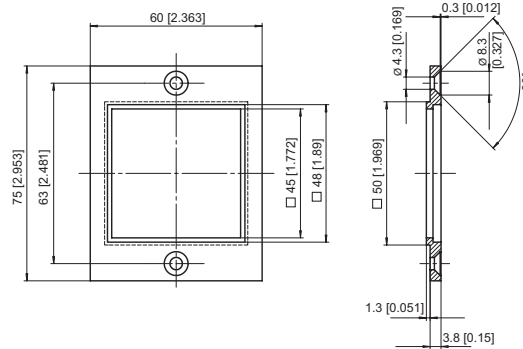

Adapter front bezel, 72 x 72 mm [2.83 x 2.83"]

with clip mounting
for counters 48 x 48 mm [1.89 x 1.89"]
(Mating clip must be ordered separately)



cut-out:

for cut-out 68 x 68 mm [2.68 x 2.68"]
to cut-out 45 x 45 mm [1.77 x 1.77"]

suitable for:

901, Codix 716 / 717,
Codix 923 / 924, Codix 907 / 908,
H 57, HC 77, HW 66, HW 66 M

grey
black
mating clip

Order-No.

T008176
T008177
T009420

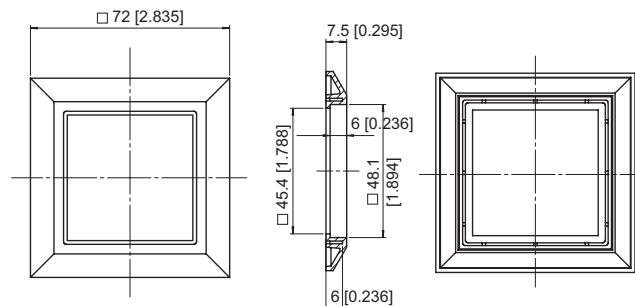

Adapter front bezel, Ø 72 mm [2.83"]

with clip mounting
for counters 48 x 48 mm [1.89 x 1.89"]



cut-out:

for cut-out Ø 60 mm [2.36"]
to cut-out 45 x 45 mm [1.77 x 1.77"]

suitable for:

901, Codix 716 / 717,
Codix 923 / 924, Codix 907 / 908,
H 57, HC 77, HW 66, HW 66 M

black

Order-No.

N510226

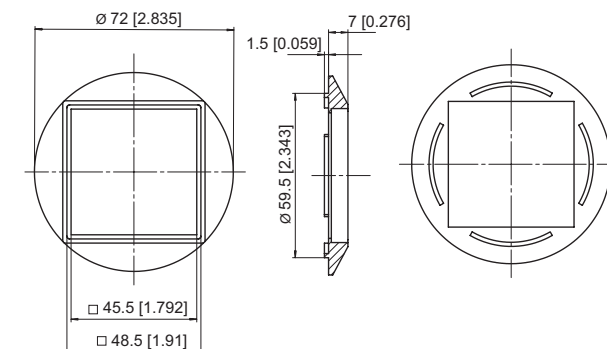

Accessories

Sealing cover Details

Dimensions / Details

Sealing cover type K1 (screw mounting)

for electromechanical counters
and via adapter front bezel N003001
for counters 48 x 24 mm [1.89 x 0.94"]



description:

- for front bezel 60 x 50 mm [2.36 x 1.97"]
- flexible sealing cover made of soft PVC, with varnished steel metal frame and fixing screws
- IP65 protection to DIN 40050 when installed

suitable for:

B 1x.3x, HB 2x.3x
via adapter front bezel:
Codix 13x, 14x, 52x, 53x,
W 15.5, W 16.5, W 17.5,
H 37, H 37.5

transparent /
grey
transparent /
black

Order-No.

G008300

G008301

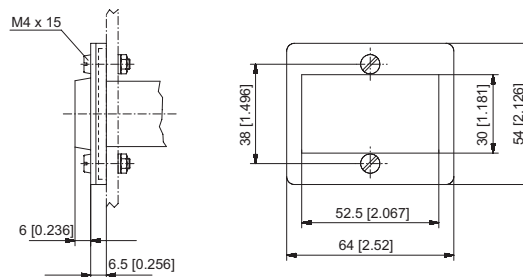

Sealing cover type K2 (screw mounting)

for electromechanical counters
and via adapter front bezel T008860
for counters 48 x 48 mm [1.89 x 1.89"]



description:

- for front bezel 75 x 60 mm [2.95 x 2.36"]
- flexible sealing cover made of soft PVC, with varnished steel metal frame and fixing screws
- IP65 protection to DIN 40050 when installed

suitable for:

BVa 15.3x, HVa 15.3x,
MVa 16.3x
via adapter front bezel:
Codix 901, Codix 716 / 717,
Codix 923 / 924,
Codix 907 / 908

transparent /
grey
transparent /
black

Order-No.

G008302

G008303

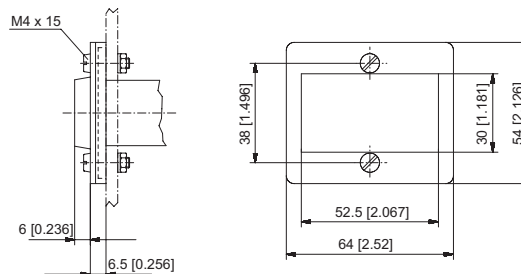

Sealing cover type KV3 (screw mounting)

for electromechanical counters



description:

- for front bezel 39 x 68 mm [1.54 x 2.68"]
- flexible sealing cover made of soft PVC, with varnished steel metal frame and fixing screws
- IP65 protection to DIN 40050 when installed

suitable for:

MVs 13.1x

transparent /
grey
transparent /
black

Order-No.

G008310

G008311

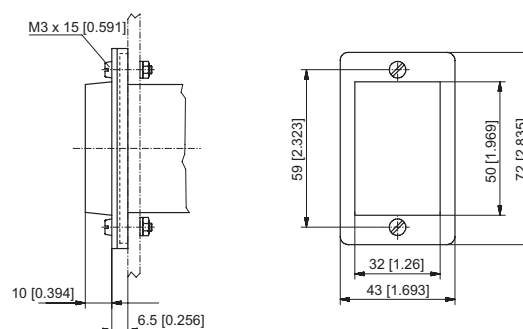

Accessories

Transparent cover

Dimensions / Details

Transparent cover type 1 Dv (replacement part)
lockable, IP65

description:

- screw-on, for size F1
- IP65 protection
- with gaskets and screws

suitable for:

Dv B 1x, Dv HB 2x transparent

Order-No.

G008121

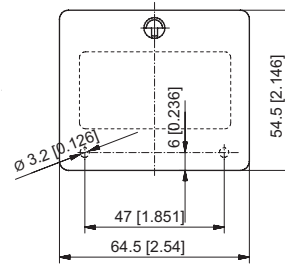
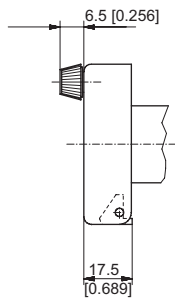

Transparent cover type 1 Dvs (replacement part)
key lockable, IP65

description:

- screw-on, for size F1
- IP65 protection
- with gaskets and screws

suitable for:

Dvs B 1x, Dvs HB 2x transparent

Order-No.

G008131

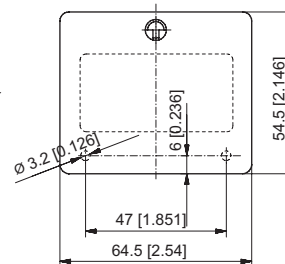
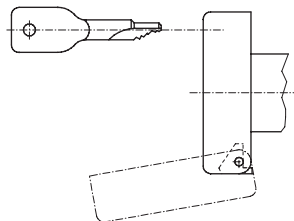

Transparent cover type 2 Dv (replacement part)
lockable, IP65

description:

- screw-on, for size F2
- IP65 protection
- with gaskets and screws

suitable for:

Dv BVa 15, Dv HVa 15, transparent
Dv MVs 16

Order-No.

G008141

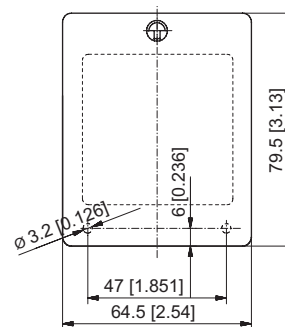
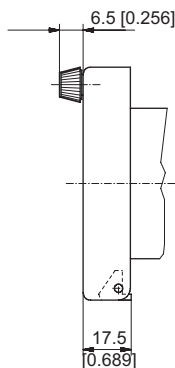

Accessories

Transparent cover

Dimensions / Details

Transparent cover type 2 Dvs, (replacement part) key lockable, IP65



description:

- screw-on, for size F2
- IP65 protection
- with gaskets and screws

suitable for:

Dvs BVa 15, Dvs HVa 15, transparent
Dvs MVs 16

Order-No.

G008151

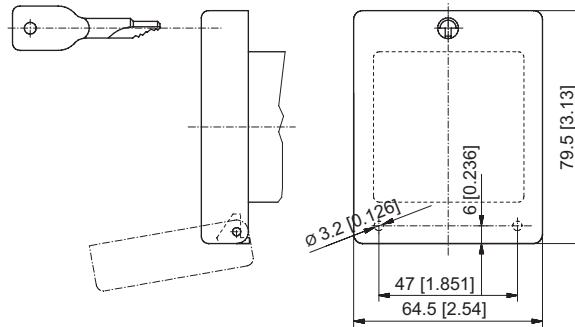

Transparent cover type 2 Dv (mounted on bezel) lockable, IP65

for counter with cut-out 45 x 45 mm [1.77 x 1.77"] and front bezel 48 x 48 mm [1.89 x 1.89"]



description:

- for cut-out 50 x 50 mm [1.97 x 1.97"]
- screw mounting
- IP65 protection
- with gaskets and screws

suitable for:

901, Codix 716 / 717, transparent/
Codix 923 / 924, black
Codix 907 / 908,
H 57, HC 77, HW 66, HW 66 M

Order-No.

G008143

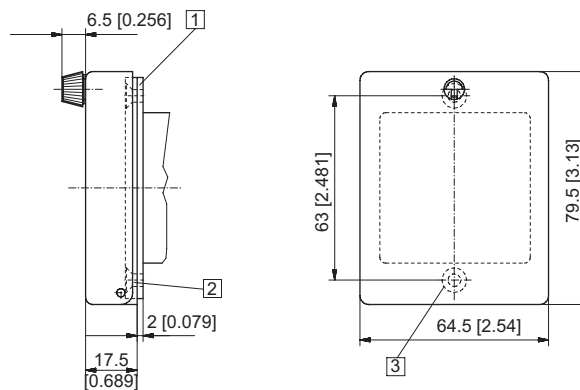

1 Gasket

2 Front bezel

3 Countersinking Bf4, DIN 74

Transparent cover type 2 Dvs (mounted on bezel) key lockable, IP65

for counters with cut-out 45 x 45 mm [1.77 x 1.77"] and front bezel 48 x 48 mm [1.89 x 1.89"]



description:

- for cut-out 50 x 50 mm [1.97 x 1.97"]
- screw mounting
- IP65 protection
- with gaskets and screws

suitable for:

901, Codix 716 / 717, transparent/
Codix 923 / 924, black
Codix 907 / 908,
H 57, HC 77, HW 66, HW 66 M

Order-No.

G008153

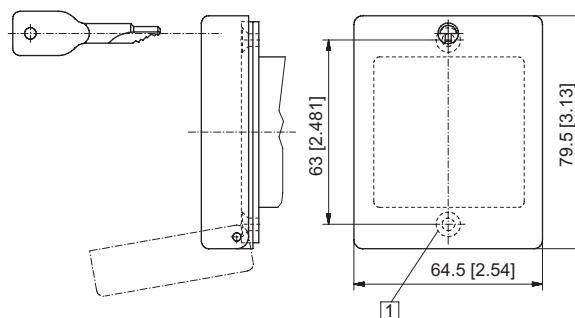

1 Countersinking Bf4, DIN 74

Transparent cover Details

Dimensions / Details

Transparent cover type 1 Dv (mounted on bezel) lockable, IP65

for counters with cut-out 50 x 25 mm [1.97 x 0.98"] or
45 x 22.2 mm [1.77 x 0.94"]



- 1 Front bezel
- 2 Countersinking Bf4, DIN 74

description:

- for cut-out 54 x 29 mm [2.13 x 1.14"]
- screw mounting on front bezel F1B
or adapter front bezel N003001
- IP65 protection with front bezel

suitable for:

B 1x.3x, HB 2x.3x

transparent /
black

with front bezel F1B:
B 1x.0x, HB 2x.0x

via adapter front bezel
N003001:
Codix 13x, 14x, 52x, 53x,
W 15.5, W 16.5, W 17.5,
H 37, H 37.5

Order-No.

N003002

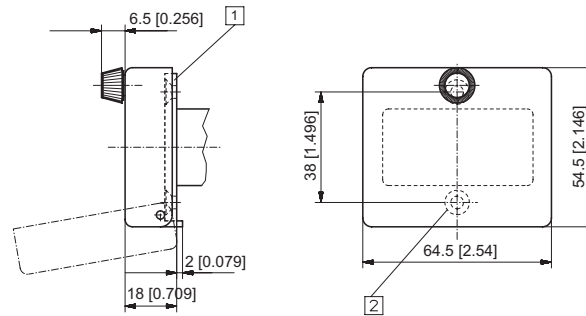

Accessories

Socket box Details

Dimensions / Details

Socket box type 945.2

description:

for plug-in connection in front bezel F1B

suitable for:

B 1x.0x, HB 2x.0x

black

Order-No.

G008434



1 Flat pin 0.8 x 2.8 [0.032 x 0.11"] silver-plated

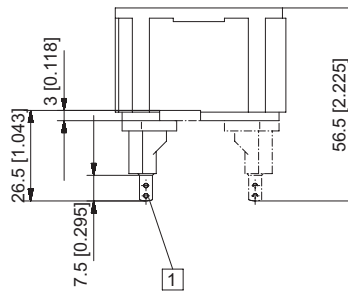
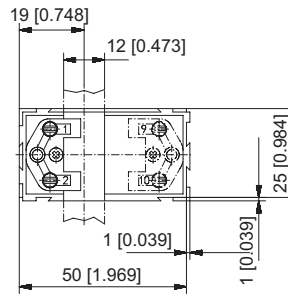

Accessories

Socket box Details

Dimensions / Details

Socket box type 926.1



description:

for plug-in connection in

suitable for:

MVs 16

transparent

Order-No.

G008433

Socket box type 946.1

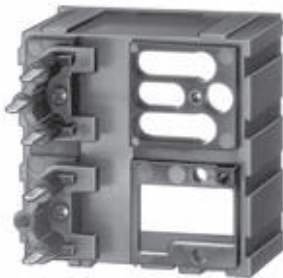

description:

for plug-in connection in
front bezel F2B

suitable for:

BVa 15, HVa 15

black

Order-No.

G008439

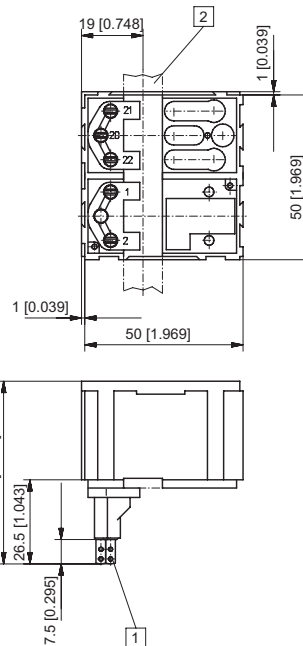

1 Flat pin 0.8 x 2.8 [0.032 x 0.11"] silver-plated

2 Fixing strip 3 x 12 mm [0.12 x 0.47"]

Accessories

Front bezel Details

Dimensions / Details

Front bezel type F1B

for plug-in counters B 1x.0x and HB 2x.0x in socket box type 945.2



description:

- for cut-out 54 x 49 mm [2.13 x 1.93"]
- screw mounting

suitable for:

B 1x.0x, HB 2x.0x

beige
black

Order-No.

G007501
G007502

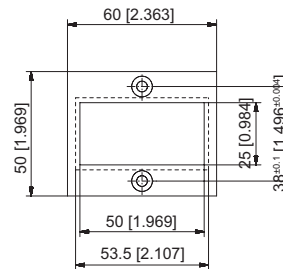
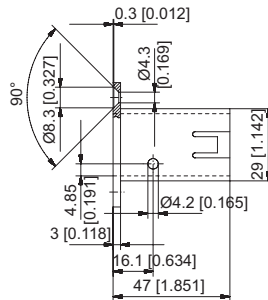

Front bezel type F2B

for plug-in counters BVa 15.0x in socket box type 946.1 or 2 x B- or HB counters in socket box type 945.2



description:

- for cut-out 54 x 54 mm [2.13 x 2.13"]
- screw mounting

suitable for:

BVa 15.0x

beige
black

Order-No.

G007503
G007504

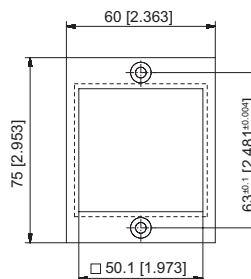
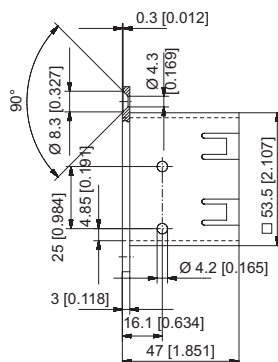

Accessories

Mounting frame Details

Dimensions / Details

Mounting frame with cut-out 92 x 45 mm [3.62 x 1.77"]

for counters 96 x 48 mm [3.78 x 1.89"]



description:

for snap-on mounting on
35 mm [1.38"] top-hat DIN rail

suitable for:

Codix 54x, 55x, 56x, 57x grey

Order-No.

G300005

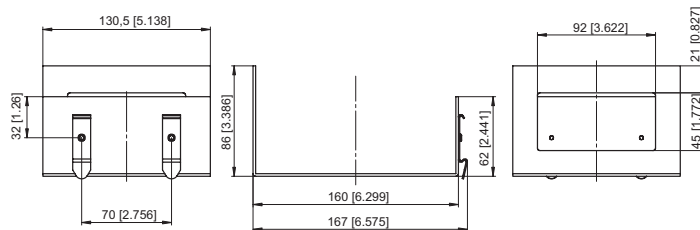

Mounting frame with cut-out 50 x 50 mm [1.97 x 1.97"] (cut-out 45 x 45 mm [1.77 x 1.77"] via supplied adapter)

for counters 48 x 48 mm [1.89 x 1.89"], 53 x 53 mm
[2.09 x 2.09"] and 55 x 55 mm [2.16 x 2.16"]



description:

for snap-on mounting on
35 mm [1.38"] top-hat DIN rail

suitable for:

901, Codix 716 / 717, chromated
Codix 923 / 924, Codix 907 / 908,
H 57, HC 77, HW 66, HW 66 M,
BVa 15.21, HVa 15.21,
MV's 16.2x

Order-No.

G300003

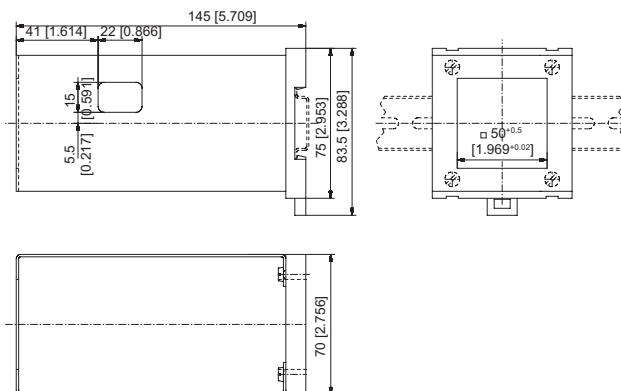

Mounting frame with cut-out 50 x 25 mm [1.97 x 0.98"] (cut-out 45 x 22.2 mm [1.77 x 0.94"] via separate adapter)

for counters 53 x 28 mm [2.09 x 1.10"]
and via separate adapter (T008180) for counters
48 x 24 mm [1.89 x 0.94"]



description:

for snap-on mounting on
35 mm [1.38"] top-hat DIN rail

suitable for:

B 1x.2x, HB 2x.2x. chromated
via adapter:
Codix 13x, 14x, 52x, 53x,
W 15.5, W 16.5, W 17.5,
H 37, H 37.5

Order-No.

G300004

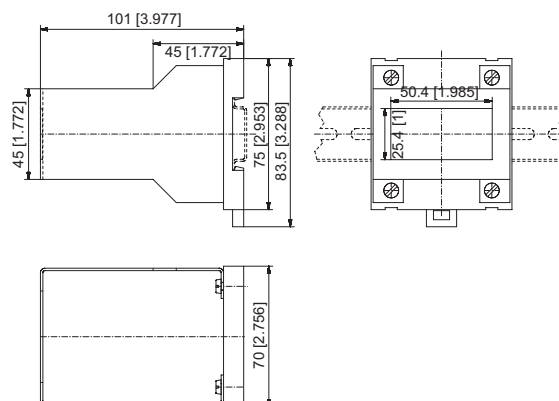

Accessories

DIN rail mount Details

Dimensions / Details

DIN rail mount SR 1

for B and HB counters



description:

for snap-on mounting on
35 mm [1.38"] top-hat DIN rail

suitable for:

B and HB counters

Order-No.

G300000

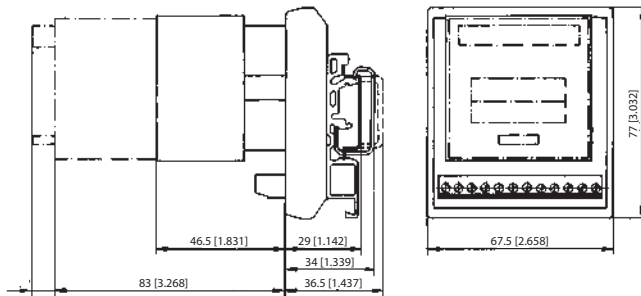

DIN rail mount SR 2

for 2 x B and HB counters

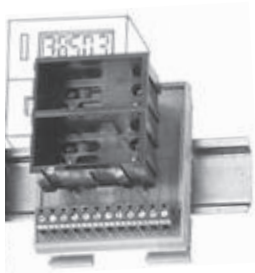

description:

for snap-on mounting on
35 mm [1.38"] top-hat DIN rail

suitable for:

B and HB counters

Order-No.

G300001

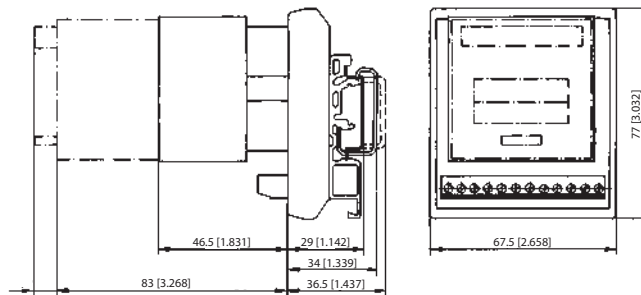

DIN rail mount SR 3

for BVa and HVa counters

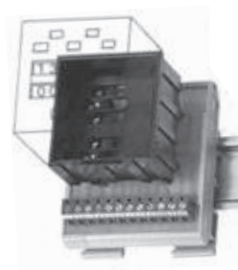

description:

for snap-on mounting on
35 mm [1.38"] top-hat DIN rail

suitable for:



BVa and HVa counters

Order-No.

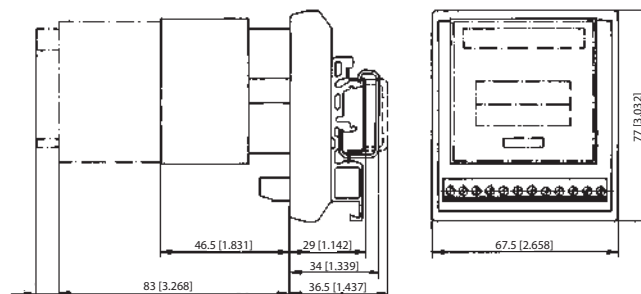



G300002



Accessories

Enclosure blind	Details		
<p>Dimensions / Details</p> <p>Enclosure blind, 48 x 24 mm [1.89 x 0.94"] for counters 48 x 24 mm [1.89 x 0.94"] and 53 x 28 mm [2.09 x 1.10"] (via adapter front bezel T008180 or T008181; included in delivery)</p> 	<p><i>cut-out</i></p> <p>for cut-out 45 x 22.2 mm [1.77 x 0.94"] and cut-out 50 x 25 mm [1.97 x 0.98"]</p>	<p><i>suitable for:</i></p> <p>Codix 13x, 14x, 52x, 53x, W 15.5, W 16.5, W 17.5, H 37, H 37.5</p> <p>anthracite</p>	<p><i>Order-No.</i></p> <p>G003836</p>
<p>Enclosure blind, 53 x 28 mm [2.09 x 1.10"] for counters 53 x 28 mm [2.09 x 1.10"]</p> 	<p><i>cut-out</i></p> <p>for cut-out 50 x 25 mm [1.97 x 0.98"]</p>	<p><i>suitable for:</i></p> <p>B and HB counters</p> <p>black</p>	<p><i>Order-No.</i></p> <p>T005753</p>

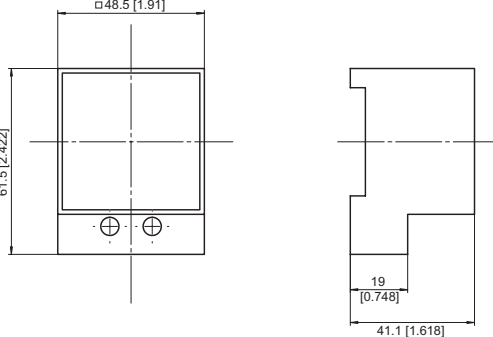
Accessories

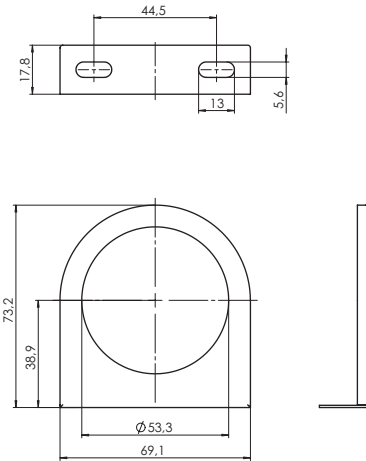
Other accessories	Details			
<p>Dimensions / Details</p> <p>Terminal cover type KA 37 for counter H 37</p> 	<p><i>description:</i> 2-pcs. per counter required</p> 	<p><i>suitable for:</i> H 37</p>	<p>transparent</p>	<p><i>Order-No.</i> T051687</p>
<p>Base mount socket for H 57 / AH 57 counters</p> 	<p><i>description:</i> for DIN rail mount</p> 	<p><i>suitable for:</i> H 57</p>	<p>black</p>	<p><i>Order-No.</i> G008040</p>
<p>Mounting support for HR 76.2, HR 47</p> 	<p><i>description:</i> for mounting the counter onto a flat plate</p> 	<p><i>suitable for:</i> HR 76.2, HR 47</p>	<p>black</p>	<p><i>Order-No.</i> N510199</p>

Other accessories	Details			Order-No.
-------------------	---------	--	--	-----------

Dimensions / Details

Adapter and anti-vibration set

for HR 47



description:

Adapter- und anti-vibrationsset for panel cut-out \varnothing 71 mm [2.80"], outer diameter \varnothing 80 mm [3.15"]

suitable for:

HR 47

black

Order-No.

255319

Delivery specification:

- 1 x rubber adapter
- 2 x cover mask
- 1 x spacer ring
- 1 x clamping bracket, shortened

Accessories

Gaskets		Overview		
Gasket, outer diameter	for cut-out	suitable for		Order-No.
60 x 75 mm [2.36 x 2.95"]	54.4 x 54.4 mm [2.14 x 2.14"]	F2B (G007503, G007504) + BVa 15.0x, MVs 16, T008860	black	N511003
58 x 58 mm [2.28 x 2.28"]	50.2 x 50.2 mm [1.98 x 1.98"]	BVa 15.2x, HVa 15.2x, MVs 16.2x, T008853	black	N511004
60 x 50 mm [2.36 x 1.97"]	54.4 x 29.4 mm [2.14 x 1.16"]	F1B (G007501, G007502) + B 1x.0x, HB 2x.0x, N003001	black	N511005
58 x 33 mm [2.28 x 1.30"]	50.2 x 25.2 mm [1.98 x 0.99"]	B 1x.2x, HB 2x.2x	black	N511006
39 x 40 mm [1.54 x 1.57"]	33.3 x 22 mm [1.31 x 0.87"]	Mk 14.11, PMk 14.11, Hk 17.151	black	N511011
53 x 28 mm [2.09 x 1.10"]	50 x 25 mm [1.97 x 0.98"]	B 1x.2x, HB 2x.2x, H 37.2, H 37.4, T008164, T008165, T008180	black	N511015
72 x 72 mm [2.83 x 2.83"]	ø 50.5 [1.99"] and 45 x 45 mm [1.77 x 1.77"]	H 57.72, HC 77.72, T008176, T008177	black	N511016
55 x 55 mm [2.16 x 2.16"]	ø 50.5 [1.99"] and 45 x 45 mm [1.77 x 1.77"]	H 57.55, HC 77.55, T008171, T008170	black	N511017
48 x 48 mm [1.89 x 1.89"]	ø 50 [1.97"] and 45 x 45 mm [1.77 x 1.77"]	H 57, HC 77, HW 66	black	N511018
60 x 50 mm [2.36 x 1.97"]	50 x 25 mm [1.97 x 0.98"]	B 1x.3x, HB 2x.3x	black	N511019
60 x 75 mm [2.36 x 2.95"]	50 x 50 mm [1.97 x 1.97"]	BVa 15.3x, HVa 15.3x, MVs 16.3x, T008860	black	N511020
48 x 48 mm [1.89 x 1.89"]	45 x 45 mm [1.77 x 1.77"]	901, Codix 716 / 717, Codix 923 / 924, Codix 907 / 908, H 57, HC 77, HW 66	black	N511028
48 x 24 mm [1.89 x 0.94"]	45 x 22 mm [1.77 x 0.87"]	Codix 13x, Codix 14x, Codix 52x, Codix 53x, W 15.5, W 16.5, W 17.5, H 37, H 37.5	black	N511029
55 x 31.5 mm [2.17 x 1.24"]	37 x 24 mm [1.46 x 0.94"]	HK 17.611	black	N511030
96 x 49 mm [3.78 x 1.93"]	92 x 45 mm [3.62 x 1.77"]	Codix 54x, Codix 55x	black	N511031
49 x 49 mm [1.93 x 1.93"]	45 x 45 mm [1.77 x 1.77"]	901, Codix 716 / 717, Codix 923 / 924, Codix 907 / 908, H 57, HC 77, HW 66	black	N511033
49 x 25 mm [1.93 x 0.98"]	45 x 22 mm [1.77 x 0.87"]	Codix 13x, Codix 14x, Codix 52x, Codix 53x, W 15.5, W 16.5, W 17.5, H 37, H 37.5	black	N511034
36 x 24 mm [1.42 x 0.94"]	33.3 x 22 mm [1.31 x 0.87"]	HK 17.251 ... 56	black	N511040
55 x 26 mm [2.17 x 1.02"]	33.3 x 22 mm [1.31 x 0.87"]	HK 17.451	black	N511043
ø 71.1 mm [2.80"]	ø 50.8 mm [2"]	HR 76.1	black	N511150
96 x 48 mm [3.78 x 1.89"]	92 x 45 mm [3.62 x 1.77"]	Codix 56x	black	N511181
ø 58 mm [2.28"]	ø 50 mm [1.97"]	HR 47	black	N511182

List of order numbers

Order-No.	Type / Description	Page
0.135.100.XXX	HR 76.1	198
0.135.200.XXX	HR 76.2	198
0.170.000.XXX	SH 17	194
0.570.010.305	570	235
0.570.011.E00	570	235
0.570.012.EXX	570	235
0.571.011.E00	571	246
0.571.012.EXX	571	246
1.100.200.XXX	K 04.20	88
1.100.401.XXX	K 04.40	88
1.110.200.XXX	K 05.20	88
1.120.200.XXX	K 06.20	88
1.120.800.XXX	K 06.80	88
1.130.000.XXX	AK 07.00	88
1.130.200.XXX	K 07.20	88
1.130.401.XXX	K 07.40	88
1.130.501.XXX	K 07.50	88
1.130.800.XXX	K 07.80	88
1.130.900.XXX	K 07.90	88
1.132.101.XXX	SK 07.1	94
1.150.210.XXX	W 15.21	96
1.150.510.XXX.550	W 15.51	96
1.160.200.XXX	W 16.20	99
1.160.601.XXX	W 16.60	99
1.180.110.XXX	Bk 14.11	102
1.180.210.XXX	Bk 14.21	102
1.230.012.XXX	B 16.01	104
1.230.100.XXX	B 16.10	104
1.230.110.XXX	B 16.11	104
1.230.200.XXX	B 16.20	104
1.230.210.XXX	B 16.21	104
1.230.300.XXX	B 16.30	104
1.230.310.XXX	B 16.31	104
1.260.002.XXX	B 18.00	104
1.260.100.XXX	B 18.10	104
1.260.200.XXX	B 18.20	104
1.260.300.XXX	B 18.30	104
1.310.110.XXX	Mk 14.11	110
1.310.210.XXX	Mk 14.21	110
1.330.200.XXX	Mk 16.20	110
1.340.110.XXX	Mk 16.11	110
1.340.210.XXX	Mk 16.21	110
1.340.230.XXX	Mk 16.23	110
162704 Set	Adapter front bezel, 72 x 36 mm [2.83 x 1.42"]	308
1.650.910.XXX	K 66.91	85
1.650.950.XXX	K 66.95	85
1.660.200.XXX	K 67.20	85
1.660.800.XXX	K 67.80	85
1.660.900.XXX	K 67.90	85
1.660.910.XXX	K 67.91	85
1.660.950.XXX	K 67.95	85
1.700.200.XXX	K 46.20	82

Order-No.	Type / Description	Page
1.700.800.XXX	K 46.80	82
1.700.900.XXX	K 46.90	82
1.700.950.XXX	K 46.95	82
1.710.200.XXX	K 47.20	82
1.710.800.XXX	K 47.80	82
1.710.900.XXX	K 47.90	82
1.710.910.XXX	K 47.91	82
1.740.500.XXX.550	W 17.50	99
1.740.900.XXX	W 17.90	99
1.943.XXX.XXX.XXX	KWh 17	113
1.944.XXX.XXX.XXX	KWh 17	113
1.945.XXX.XXX.XXX	KWh 17	113
2.100.010.XXX	BVa 15.01	146
2.100.110.XXX	BVa 15.11	146
2.100.210.XXX	BVa 15.21	146
2.100.310.XXX	BVa 15.31	146
2.300.110.XXX	MVs 13.11	150
2.300.130.XXX	MVs 13.13	150
2.300.210.XXX	MVs 13.21	150
2.300.230.XXX	MVs 13.23	150
2.310.110.XXX	MVs 13.11/2	150
2.310.130.XXX	MVs 13.13/2	150
2.310.210.XXX	MVs 13.21/2	150
2.310.230.XXX	MVs 13.23/2	150
2.320.230.XXX	MVs 16.23	153
255319	Adapter and anti-vibration set	322
3.060.200.383	HK 47.20	177
3.060.800.383	HK 47.80	177
3.100.000.383	AHK 07.00	179
3.100.200.383	HK 07.20	179
3.100.900.383	HK 07.90	179
3.100.920.383	HK 07.92	179
3.102.101.XXX	SHK 07.1	192
3.130.051.XXX	HK 17.051.39	182
3.130.251.XXX	HK 17.251.39	182
3.130.251.XXX.056	HK 17.251.39.56	182
3.130.451.XXX	HK 17.451.39	182
3.160.111.XXX	HB 26.11	200
3.160.211.XXX	HB 26.21	200
3.165.011.XXX	HB 26.01.3	200
3.200.101.XXX	HB 27.10	204
3.200.201.XXX	HB 27.20	204
3.205.001.XXX	HB 27.00.3	204
3.220.401.XXX	H 57	189
3.223.401.XXX	AH 57	189
3.240.201.XXX	H 37	185
3.241.201.XXX	H 37.1	185
3.242.201.XXX	H 37.2	185
3.245.201.XXX	H 37.5	185
3.300.211.XXX	HVa 15.21	212
3.300.311.XXX	HVa 15.31	212
3.474.901.XXX	HR 47	196

List of order numbers

Order-No.	Type / Description	Page	Order-No.	Type / Description	Page
3.474.911.XXX	HR 47	196	6.544.012.XXX	Codix 544	243
3.550.401.XXX	HC 77	207	6.54P.012.XXX	Codix 54P	257
3.551.401.XXX	HC 77.55	207	6.54U.012.XXX	Codix 54U	254
3.553.401.XXX	SHC 77	210	6.560.010.XXX	Codix 560	138
3.553.401.XXX.060	SHC 77.60	210	6.564.010.XXX	Codix 564	290
3.563.201.XXX	HW 66	262	6.565.010.XXX	Codix 565	270
3.56M.201.075	HW 66 M	262	6.566.010.XXX	Codix 566	296
3.802.11X	PMk 14.11	115	6.572.0116.XXX	572	143
3.802.21X	PMk 14.21	115	6.572.0118.XXX	572	143
3.804.11X	PMk 16.11	115	6.573.011.E00	573	274
3.804.21X	PMk 16.21	115	6.573.012.E90	573	274
3.805.10X	PMk 18.10	115	6.574.0116.DXX	574	226
3.805.20X	PMk 18.20	115	6.716.01X.XXX.Ex	Codix 716	133
6.130.012.XXX	Codix 130	48	6.717.01X.XXX.Ex	Codix 717	133
6.131.012.XXX	Codix 131	51	6.901.010.800	901	120
6.132.012.XXX	Codix 132	54	6.907.010X.XXX	Codix 907	123
6.133.012.XXX	Codix 133	232	6.908.010X.XXX	Codix 908	123
6.134.012.XXX	Codix 134	158	6.923.01XX.XXX	Codix 923	126
6.135.012.XXX	Codix 135	161	6.924.01XX.XXX	Codix 924	126
6.136.012.XXX	Codix 136	218	G003836	Enclosure blind, 48 x 24 mm [1.89 x 0.94"]	320
6.140.012.300.XXXX	Codix 140	57	G007501	Front bezel type F1B, beige	317
6.141.012.300	Codix 141	164	G007502	Front bezel type F1B, black	317
6.142.011.300.XXXX	Codix 142	57	G007503	Front bezel type F2B, beige	317
6.143.011.300.XXXX	Codix 143	164	G007504	Front bezel type F2B, black	317
6.190.012.XXX	190	78	G008040	Base mount socket	321
6.192.012.300	192	80	G008121	Transparent cover type 1 Dv (replacement part)	312
6.194.012.XXX	194	173	G008131	Transparent cover type 1 Dvs (replacement part)	312
6.198.012.300	198	175	G008141	Transparent cover type 2 Dv (replacement part)	312
6.520.012.3XX	Codix 520	60	G008143	Transparent cover type 2 Dv, mounted on bezel	313
6.521.01X.3XX	Codix 521	63	G008151	Transparent cover type 2 Dvs (replacement part)	313
6.522.011.3XX	Codix 522	220	G008153	Transparent cover type 2 Dvs, mounted on bezel	313
6.522.012.3XX	Codix 522	220	G008300	Sealing cover type K1, transparent /grey	311
6.523.011.3XX	Codix 523	167	G008301	Sealing cover type K1, transparent /black	311
6.523.012.3XX	Codix 523	167	G008302	Sealing cover type K2, transparent /grey	311
6.524.011.3XX	Codix 524	240	G008303	Sealing cover type K2, transparent /black	311
6.524.012.3XX	Codix 524	240	G008310	Sealing cover type KV3, transparent /grey	311
6.529.012.300	Codix 529	266	G008311	Sealing cover type KV3, transparent /black	311
6.52C.012.3XX	Codix 52C	69	G008433	Socket box type 926.1	316
6.52P.012.3XX	Codix 52P	251	G008434	Socket box type 945.2	315
6.52T.012.3XX	Codix 52T	66	G008439	Socket box type 946.1	316
6.52U.012.3XX	Codix 52U	248	G300000	DIN rail mount SR 1	319
6.530.012.300	Codix 530	268	G300001	DIN rail mount SR 2	319
6.531.012.300	Codix 531	284	G300002	DIN rail mount SR 3	319
6.532.012.300	Codix 532	287	G300003	Mounting frame with cut-out 50 x 50 mm [1.97 x 1.97"]	318
6.533.012.300	Codix 533	277	G300004	Mounting frame with cut-out 50 x 25 mm [1.97 x 0.98"]	318
6.540.012.XXX	Codix 540	72	G300005	Mounting frame with cut-out 92 x 45 mm [3.62 x 1.77"]	318
6.541.01X.XXX	Codix 541	75	N003001	Adapter front bezel, 60 x 50 mm [2.36 x 1.97"], black	308
6.542.011.XXX	Codix 542	223	N003002	Transparent cover type 1 Dv, mounted on bezel	314
6.542.012.XXX	Codix 542	223	N510199	Mounting support	321
6.543.011.XXX	Codix 543	170	N510226	Adapter front bezel, ø 72 mm [2.83"], black	310
6.543.012.XXX	Codix 543	170	N511003	Gasket 60 x 75 mm [2.36 x 2.95"]	323
6.544.011.XXX	Codix 544	243	N511004	Gasket 58 x 58 mm [2.28 x 2.28"]	323

List of order numbers

Order-No.	Type / Description	Page
N511005	Gasket 60 x 50 mm [2.36 x 1.97"]	323
N511006	Gasket 58 x 33 58 x 58 mm [2.28 x 1.30"]	323
N511011	Gasket 39 x 40 mm [1.54 x 1.57"]	323
N511015	Gasket 53 x 28 mm [2.09 x 1.10"]	323
N511016	Gasket 72 x 72 mm [2.83 x 2.83"]	323
N511017	Gasket 55 x 55 mm [2.16 x 2.16"]	323
N511018	Gasket 48 x 48 mm [1.89 x 1.89"]	323
N511019	Gasket 60 x 50 mm [2.36 x 1.97"]	323
N511020	Gasket 60 x 75 mm [2.36 x 2.95"]	323
N511028	Gasket 48 x 48 mm [1.89 x 1.89"]	323
N511029	Gasket 48 x 24 mm [1.89 x 0.94"]	323
N511030	Gasket 55 x 31,5 mm [2.17 x 1.24"]	323
N511031	Gasket 96 x 49 mm [3.78 x 1.93"]	323
N511033	Gasket 49 x 49 mm [1.93 x 1.93"]	323
N511034	Gasket 49 x 25 mm [1.93 x 0.98"]	323
N511040	Gasket 36 x 24 mm [1.42 x 0.94"]	323
N511043	Gasket 55 x 26 mm [2.17 x 1.02"]	323
N511150	Gasket ø 71.1 mm [2.80"]	323
N511181	Gasket 96 x 48 mm [3.78 x 1.89"]	323
N511182	Gasket ø 58 mm [2.28"]	323
T005753	Enclosure blind, 53 x 28 mm [2.09 x 1.10"]	320
T008161	Adapter front bezel, 56 x 40 mm [2.20 x 1.57"], black	308
T008164	Adapter front bezel, 53 x 28 mm [2.09 x 1.10"], grey	308
T008165	Adapter front bezel, 53 x 28 mm [2.09 x 1.10"], black	308
T008170	Adapter front bezel, 55 x 55 mm [2.16 x 2.16"], grey	309
T008171	Adapter front bezel, 55 x 55 mm [2.16 x 2.16"], black	309
T008176	Adapter front bezel, 72 x 72 mm [2.83 x 2.83"], grey	310
T008177	Adapter front bezel, 72 x 72 mm [2.83 x 2.83"], black	310
T008180	Adapter front bezel, 53 x 28 mm [2.09 x 1.10"], anthracite	308
T008181	Adapter front bezel, 56 x 40 mm [2.20 x 1.57"], anthracite	308
T008853	Adapter front bezel, 55 x 55 mm [2.16 x 2.16"], black	309
T008860	Adapter front bezel, 60 x 75 mm [2.36 x 2.95"], black	310
T008883	Adapter front bezel, 48 x 48 mm [1.89 x 1.89"], black	309
T009420	Adapter front bezel, 72 x 72 mm [2.83 x 2.83"], mating clip	310
T051687	Terminal cover type KA 37	321

Notes