

Time preset counters, electromechanical

Standard time preset counters

Adding 999.99 h with mechanical reset (AC+DC)

HVa 15



The time preset counters HVa 15 (with manual reset) have a robust construction.

They are used in harsh industrial environments as single counters or in combination, as a plug-in version, with other B, BVa, HB or HVa counters. They display the current counter value and the preset value.

Characteristics

- 5-digit adding time preset counter with stationary preset
- Manual reset
- Potential-free changeover contact (microswitch) when the preset time is reached
- Contact remains switched until reset occurs
- Counter without front bezel, for mounting in front bezel F2B; can be combined in 50 x 50 mm size

Benefits

- Can be combined with the counters of the B, BVa, HB and HVa series
- Counter value and preset value are constantly displayed
- Versions with transparent cover, sealing cover, lockable zero reset

Applications

Time control, automation

Type series

Description	Type	Options
Mounting clip	HVa 15.21	• Lockable 0-reset
Front bezel 3, with mounting holes	HVa 15.31	• Housing: black (standard) Art.-No. 3.30X.X17.XXX grey Art.-No. 3.30X.X16.XXX
		• HVa 15.01 (without front bezel) - plugs into socket box 946.1 - DIN Rail mount SR 3
		Housing black (standard) Art.-No. 3.300.011.XXX grey Art.-No. 3.300.010.XXX

Accessories	Dimensions in mm [inch]	Order-No.
Socket box, type 946.1	For HVa 15 for plug-in connections in front bezel F2B	black G008439
Sealing cover type K2, IP65	Suitable for front bezel 75 x 60 [2.95 x 2.36] with screw mounting	grey G008302 black G008303
Mounting frame with cut-out 50 x 50 [1.97 x 1.97] via separate adapter also for 45 x 45 [1.77 x 1.77]	For snap-on mounting on 35 [1.38] top-hat DIN rail, for counters 48 x 48 [1.89 x 1.89], 53 x 28 [2.09 x 2.09] and 55 x 55 [2.17 x 2.17]	chromated G300003
DIN rail mount SR 3	For snap-on mounting on 35 [1.38] top-hat DIN rail	G300002

Suitable gaskets as well as further accessories can be found in the accessories section or in the accessories area of our website at: www.kuebler.com/accessories.

Time preset counters, electromechanical

Standard time preset counters Adding 999.99 h with mechanical reset (AC+DC) HVa 15

General technical data		
Colour of figures	hours	figures white on black
	1/10 and 1/100 h	figures red on white
preset	hours	figures yellow on black
	1/10 and 1/100 h	figures red on white (approx. 4 mm [0.16"] high)
Reset	manual	
Mounting position	any	
Operating temperature	-15°C ... +50°C [+5°F ... +122°F] (non-condensing)	
Gasket	oil and gasoline-resistant synthetic rubber, particularly suitable for use with acids and alkalis, very good age stability	

Mechanical characteristics		
Protection		IP42 (front side)
	sealing cover K1	IP65 (front side)
	transparent cover Dv and Dvs	IP65 (front side)
Colour of housing	black (standard)	

Electrical characteristics		
Switching contact		1 changeover contact (micro switch) release at the preset time
	loading capacity at AC	max. 250 V, max. 2 A
	loading capacity at DC (ohmic load)	24 V max. 2.0 A 60 V max. 0.7 A 115 V max. 0.4 A 230 V max. 0.2 A
	With inductive load, spark quenching is required reducing the max. current to 60 %	
Test voltage	2000 V AC, 50 Hz for AC counter	
Electrical connection	tinned round pins ø 1.6 mm [0.063"], with push on connectors	
Power consumption	10 ... 30 V DC	approx. 0.5 W
	36 ... 80 V DC	approx. 0.9 W
	100 ... 130 V DC	approx. 0.75 W
	20 ... 30 V AC, 50 Hz	approx. 0.3 VA
	42 ... 48 V AC, 50 Hz	approx. 0.25 VA
	100 ... 130 V AC, 50 Hz	approx. 0.6 VA
187 ... 264 V AC, 50 Hz	approx. 1.2 VA	
360 ... 440 V AC, 50 Hz	approx. 1.65 VA	
Rated voltages	AC (50 or 60 Hz)	20 ... 30/42 ... 48/100 ... 130/187 ... 264, 360 ... 440 V
	DC	10 ... 30/36 ... 80/100 ... 130
On time	100 %	
Count mode	adding	
Count range	AC	999.99 h
	DC	9999.9 h

Hour meters / Timers

Terminal assignment

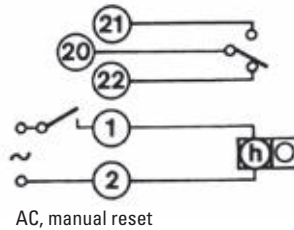
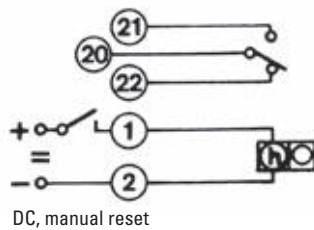

Time preset counters, electromechanical

Standard time preset counters

Adding 999.99 h with mechanical reset (AC+DC)

HVa 15

Mounting clip
Type HVa 15.21

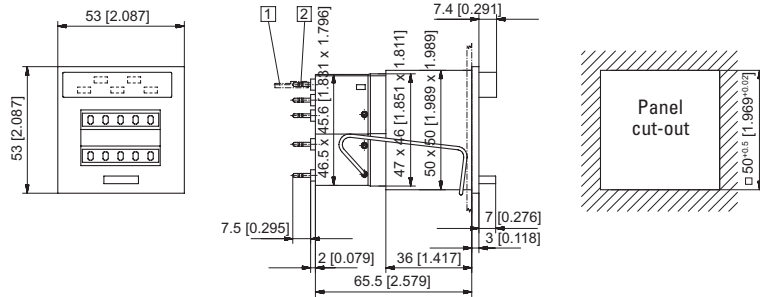

1 Push on connector \varnothing 1.5 [0.059] tinned 2 Round pin \varnothing 1.6 [0.063] tinned

Type	Voltage	Art.-No.					
		10 ... 30 V	20 ... 30 V	42 ... 48 V	100 ... 130 V	187 ... 264 V	360 ... 440 V
HVa 15.21	AC (50 Hz)		3.300.211.071	3.300.211.072	3.300.211.074	3.300.211.075	on request
	AC (60 Hz)		3.300.211.081	3.300.211.082	3.300.211.084	3.300.211.085	on request
	DC	3.300.211.351					

Front bezel 3, with mounting holes
Type HVa 15.31

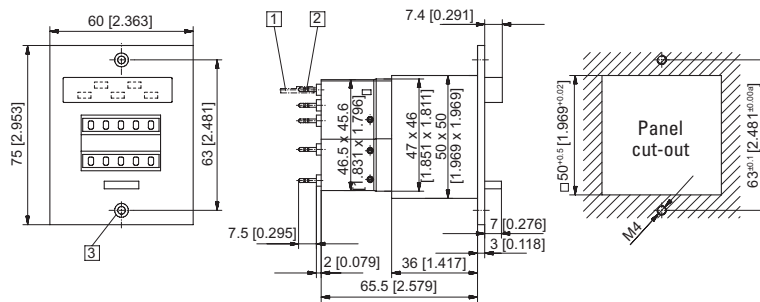

1 Push on connector \varnothing 1.5 [0.059] tinned 2 Round pin \varnothing 1.6 [0.063] tinned 3 Countersinking Af4., DIN 74

Type	Voltage	Art.-No.					
		10 ... 30 V	20 ... 30 V	42 ... 48 V	100 ... 130 V	187 ... 264 V	360 ... 440 V
HVa 15.31	AC (50 Hz)		3.300.311.071	3.300.311.072	3.300.311.074	3.300.311.075	on request
	AC (60 Hz)		3.300.311.081	3.300.311.082	3.300.311.084	3.300.311.085	on request
	DC	3.300.311.351					

Time preset counters